

# Menomonee Falls at 125

## A Timeline of Events in Village History



This timeline was compiled during March and April of 2017 by Village of Menomonee Falls staff. The events and milestones within the timeline have been included to provide a context for how the community changed through the decades. We've attempted to catalog key moments in Village (and Town) history in chronological order, but the timeline below remains a work in progress. If you have comments or suggestions regarding this timeline please contact Tyler Zwagerman at [twagerman@menomonee-falls.org](mailto:twagerman@menomonee-falls.org).

The timeline combines information from a variety of resources including the *1986 Village of Menomonee Falls Architectural and Historical Intensive Survey Report*, several Village plan and study documents, files from the Village planning and engineering archives, books from the local history collection at the Menomonee Falls Public Library, articles from the *Menomonee Falls News* (including a 1992 Centennial Celebration special edition), histories from St. Mary Parish and St. Anthony Parish and resources from the Menomonee Falls Historical Society and the Sussex-Lisbon Area Historical society. The timeline also relies on information provided in the *1967 Menomonee Falls Diamond Jubilee Brochure* and the fifth edition of the Menomonee Falls Historical Society's Centennial Issue of *Photographs and Memories: A Pictorial History of Menomonee Falls, Wisconsin* (1993). Some details from recorded accounts within the Falls Cable Access "I Remember Menomonee Falls" series and from written accounts of several individuals who graciously shared their recollections with Village staff in 2017 have also been included.

**Early 19<sup>th</sup> Century** – The area is inhabited by native groups including Menomonee and Chippewa people who maintain seasonal camps near the Menomonee River – early accounts indicate that some of these native people live in an area around the present Tamarack Preserve

**1836** – The Wisconsin Territory is organized from the western portion of the Michigan Territory after the eastern portion of the Michigan Territory applies for statehood

**1836** – Surveyor Garrett Vliet identifies and maps the area around the Menomonee River and describes the series of falls as a "respectable cataract"

**1837** – The old Green Bay trail is improved, renamed as Fond du Lac Road and designated as a state highway – today the route of the trail is followed by Appleton Avenue

**1837** – Patrick Raferty, a native of Ireland, becomes the first settler of European descent in the future Town of Menomonee

**1838-1839** – Garret Vliet purchases 640 acres at \$2.50 per acre and builds the first mill along the Menomonee River

**1839** – The Town of Menomonee is created by the Wisconsin Territorial Legislature – the Town (and later the Village) gets its name from a native word, MIH-NO-MIN-EE SEEPE, which means wild rice river

**1840** – The Town of Menomonee has a population of 59

## 1836 – Original Town of Menomonee Plat Map

**1841-1842** – The James Brogan Family builds a cabin in the area that would later be known as Lannon Springs – the Brogan Cabin is relocated to Old Falls Village historical park and restored in 1982

**1842** – Hollingsworth S. Smith constructs a log cabin and operates Garrett Vliet's sawmill east of the old Fond du Lac Road and becomes the first permanent resident of the Menomonee Falls settlement

**1842** – The first meeting of the Town of Menomonee is held at William Hesk's Travelers' Home inn and tavern – which was located near the present intersection of Appleton Avenue and Pilgrim Road (approximately where Pizza Hut is today)

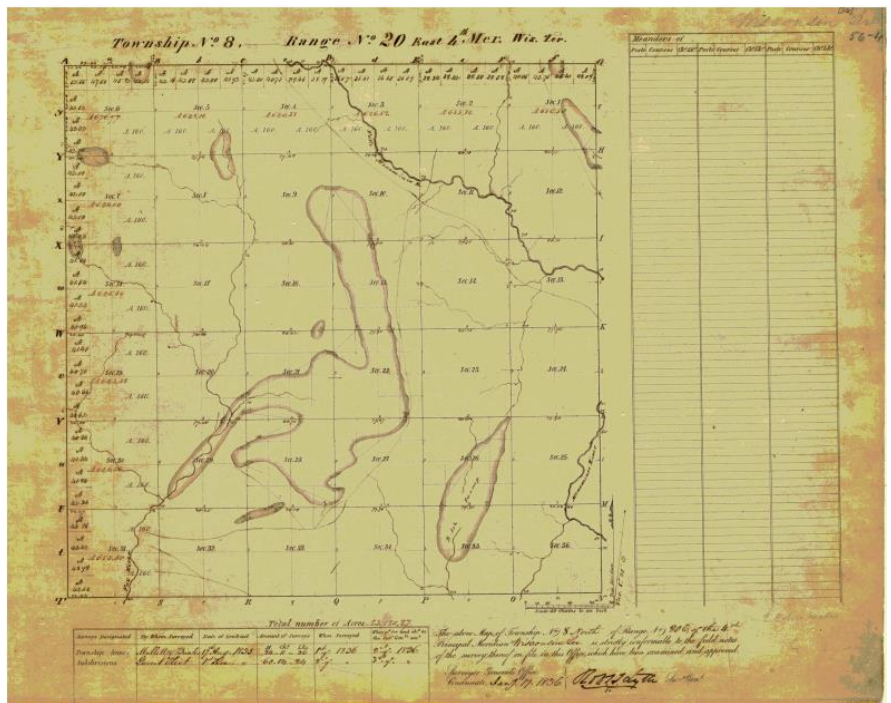

**1842** – The settlement of Lannon Springs, originally known as Willow Springs, is founded by Irish-Catholic immigrants near the present intersection of Mill Road and Town Line Road

**1842** – The native Menomonee and Chippewa are said to furnish nearly all of the meat that the early settlers had during the winter months

**1842-1843** – The first Menomonee Falls Post Office is established at William Hesk's public inn

**1843** – The first church services are held, the first school children are taught, and the first store opens in the settlement of Lannon Springs

**1843** – A log cabin school opens at the north end of the Menomonee Falls settlement near the present site of the Knights of Columbus club house

**1844-1845** – Waukesha Road (now Main Street) is surveyed and constructed between Lannon Springs and the Menomonee Falls settlement

**1844** – The Menomonee Falls settlement has a population of about 100

**1844** – Frederick Nehs, an Evangelical Pennsylvanian of German descent, purchases much of Garret Vliet's property and begins to develop new homes and businesses in the Menomonee Falls settlement including the first (two) lime kilns along the Menomonee River

**1844** – The first European settlers (including three Fuss brothers) stake claims and construct buildings along the old Fond du Lac Road in an area that would later be known as Fussville

**1845** – Water Street is constructed between Waukesha Road (Main Street) and the county line, serving as the first residential street in the Menomonee Falls settlement

**1845** – The Town of Menomonee Post Office is relocated to the Menomonee Falls settlement

**1845** – A cemetery is established at a high point to the west of Fond du Lac Road on the north end of the Menomonee Falls settlement – this later becomes the Emanuel Evangelical Church cemetery

**1845** –Johan Henry Fuss (the Fuss family patriarch) arrives at the Fussville settlement with other German-Catholic immigrants – a log church is constructed there in 1846 and dedicated as St. Anthony the Hermit Church

**1846** – Waukesha County is formed – the area had previously comprised the western portion of Milwaukee County

**1846** – Francis Waterlin settles in Menomonee Falls and opens one of the settlement’s first taverns shortly thereafter – the tavern later came to be known as the Eagle Hotel

**1846** – Emmanuel Evangelical Church is organized – the congregation meets in homes until a church building is constructed at the northwest corner of Appleton Avenue and Roosevelt Drive in 1861

**1846** – The Milwaukee and Lisbon Plank Road opens along the southern border of the Town of Menomonee (the plank road followed the existing route of Lisbon Road) – a crumbling stone bridge today marks the historic river crossing for the road

**1848** – St. James Catholic Church is built along Town Line Road in Lannon Springs – the church building remains today and is considered to be the oldest existing church in the Village

**1849** – Adolph Birkhauser opens a brewery in the Fussville settlement

**1850** – The population of the Town of Menomonee is 1,340

**1850** – Lands around the intersection of Fond du Lac Road and Waukesha Road are platted into a few dozen parcels and developed as the “Four Corners” commercial area

**1851** – Jesse Nehs builds a dam and a four story stone flour mill on the west side of the current Mill Pond

**1851** – The first wood frame school house is constructed in the Menomonee Falls settlement on Fond du Lac Road south of the Four Corners at a cost of \$55 – this structure is moved to Old Falls Village historical park in the 1970s

**1851** – A bridge built of tamarack wood is constructed across the Menomonee River in the center of the Menomonee Falls settlement at a cost of \$75

**1853** – The settlement’s first general store is built at the northeast corner of the Four Corners

**1854** – William N. Lannon opens Lannon Springs Post Office

**1855** – The Methodist Episcopal congregation builds a wooden church on Fond du Lac Road (now Appleton Avenue) – this is current location of St. Paul’s United Church of Christ

**1855** – A new log building is constructed to serve as St. Anthony Church in the Fussville settlement on a hill which had reportedly been a Native American gathering site – nuns operate a school on the site starting in the same year

**1856** – The Menomonee Falls Post Office is destroyed by fire

**1856** – Charles Nehs builds a sawmill along the Menomonee River south of Main Street in the Menomonee Falls settlement

**1858** – The Menomonee Falls settlement welcomes the arrival of its first permanent local doctor

**1859** – A local chapter of the International Order of Good Templars is founded – a meeting lodge was built the next year on west Main Street where it existed until it was razed in the 1950s

**1860** – The population of the Town of Menomonee is 2,267 and the population of the Menomonee Falls settlement is estimated to be over 200 – some 40 craftsmen, merchants and professionals call the settlement home

**1860** – An estimated 25 percent of the Menomonee Falls settlement's adult population is of Pennsylvania birth

**1861** – Emanuel Evangelical Church is completed at the intersection of Fond du Lac Road and Third Street (presently Appleton Avenue and Roosevelt Drive) on a site which was donated by Frederick Nehs – the building cost \$5,000 to construct

**1861-1865** – Many local men serve for the Union forces during the Civil War – the Village continues to grow despite the trying times

**1862** – Dr. William Hoyt, who began practicing medicine in the Village in 1857, builds a cooper shop making hardwood barrels for local businesses and for flour mills in Cedarburg and Milwaukee

**1862** – John D. Beringer and Adam Ploss build a door and woodworking factory near the lower falls

**1864** – The Fussville Post Office opens – a brewery operates simultaneously within the same building

**1864** – The original school and convent at the St. Anthony Parish site burn to the ground in Fussville

**1866** – A stone bridge is completed at Main Street over the Menomonee River

**1866** – Charles Nehs builds a two story sawmill to the south of the new Main Street Bridge

**1867** – St. Anthony Catholic Church is dedicated (replacing the original log buildings) in the settlement of Fussville – the building took three years to build at a cost of \$23,000 and was later described as “one of the most spectacular rural stone churches in southeastern Wisconsin”

**1867** – A two room brick school house is built on Main Street to replace the one room wooden structure that was used until that time – the new school accommodates up to 100 students and is heated annually with 10 cords of wood at a cost of \$25

**1868** – Methodist Episcopal Church is built for \$7,500 on the east side of Fond du Lac Road (now Appleton Avenue), north of Main Street with a 120 foot bell tower – in recent decades this building has been used as apartments

**1868** – St. Paul Evangelical Church is organized and the congregation uses the old Methodist Episcopal Church building

**1869** – I.B. Rowell & Co. Agricultural Works begins to manufacture plows, seeders, cultivators, drags and hay tedders – the company remains in Menomonee Falls until 1912 when it relocates to Waukesha

**1869** – The Coates and Ostrander store is completed on the southeast corner of the Four Corners – this building later houses the Lohmiller Drug store and today is home to Nino's Italian Bakery & Deli

**1870** – The population of the Town of Menomonee is 2,350 – the Menomonee Falls settlement population is estimated to be 300

**1870s** – The Fussville settlement boasts a post office, stores, a blacksmith shop, several hotel/taverns, a brewery and several homes

**1872** – The Lincoln Lodge of Free and Accepted Masons is founded in the Menomonee Falls settlement

**1872** – A local foundry and its contents are destroyed by fire

**1873** – A national economic depression and the loss of population to western states reduce the rate of growth in the Village

**1873** – Hoenig and Lohn Clothing Store is built along Main Street – today this building is occupied by AJ O’Brady’s Irish Pub and Grill

**1875** – Sunnyside School is built near the intersection of Main Street and Menomonee Avenue – an addition to the school is completed 77 years later in 1952

### 1873 – Town of Menomonee Plat Map

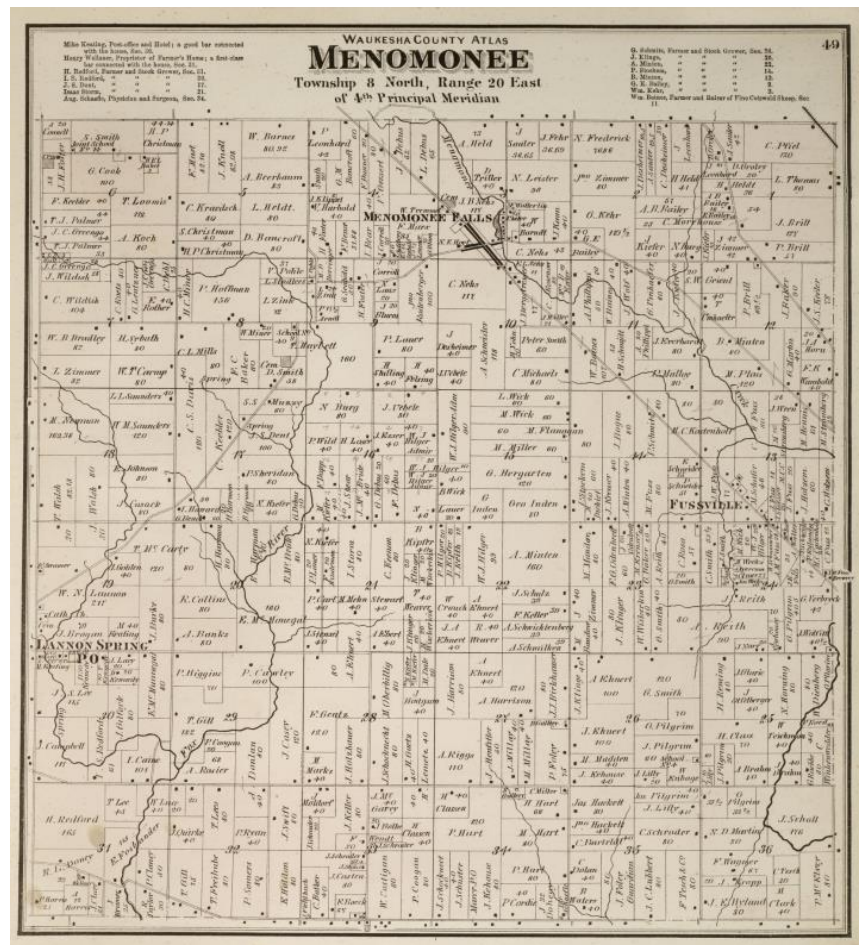

**1875** – The Lannon Springs Hotel is constructed at the southeast corner of Town Line Road and Mill Road – The tavern at this hotel may have earned the Lannon Springs settlement the nickname “Whiskey Corners”

**1875** – The Menomonee, Granville and Germantown Mutual Insurance Company is organized

**1876** – The estimated population of the Fussville settlement is 382 – at the time this was comparable to the population of the Menomonee Falls settlement

**1879** – The first Menomonee Town Hall is erected along Town Hall Road between Good Hope Road and Menomonee Avenue (near the present location of Community Memorial Hospital) – this was the first permanent location for Town Board meetings

**1879** – Adam Ploss builds a carpentry shop near the Main Street bridge in Menomonee Falls – today this building is occupied by Stanford Art Glass Studio

**1880** – The population of the Town of Menomonee is 2,258 – the Menomonee Falls settlement population is estimated to be 350

**1880s** – The Menomonee Falls settlement has three churches, two gristmills, two general stores, a foundry and farm implement plant, two wagon-maker's shops, three blacksmith's shops, two hotels, two butchers and a variety of tradesmen

**1880** – St. Paul Evangelical Church (later known as St. Paul Evangelical and Reformed Church and now St. Paul United Church of Christ) is built with stone construction on Appleton Avenue replacing the old wooden church building on the site – German language worship services continue at this church into the 1930s

**1881** – Eleven feet of snow falls in a season that is later remembered as “the granddad of all snow winters”

**1882** – Two local students have the honor of being the first high school graduating class

**1885** – A “dinky” (short line) railway is built through the Town of Menomonee between the settlements of Lannon and Butler

**1885** – A bell tower is completed at St. James Catholic Church in the Lannon Springs settlement

**1886** – The new Eagle Hotel opens in Menomonee Falls – in later years the hotel becomes a well-known eatery, renowned for its all you can eat 75 cent family-style chicken dinner

**1886** – The original Mill Pond dam and Main Street Bridge are washed out and rebuilt

**1886** – Several new streets and dozens of residential lots are created to the northeast of the Four Corners when Jesse B. Nehs subdivides his farm

**1887** – Menomonee Falls records its first Village-wide plat map – the map contains 117 parcels

**1890** – The population of the Town of Menomonee is 2,480 – the Menomonee Falls settlement has a population of 422

**1890s** – A new commercial cluster develops at the intersection of Main Street and Water Street, and five subdivisions are platted adding dozens of residential home sites

**1890s** – Fourth of July Celebrations include a parade, a picnic and fireworks display at John Martin's Orchard (now Village Park and North Middle School)

**1890s** – The final remaining groups of Native Americans migrate from the area

**1890** – The Milwaukee, Menomonee Falls & Western Railroad service begins and a rail depot is constructed along Water Street – the rail line is utilized by local businesses and for daily transportation for local workers and students attending school in Menomonee Falls

**1890** – The first edition of the *Menomonee Falls News* is published, rebranding the *Menomonee Falls Times* which began circulation a year earlier

**1890** – Garwin A. Mace buys a dozen acres alongside the Menomonee River and builds three lime kilns, establishing the Marble Gloss Lime Company

**1891** – E.L. Nehs surveys and maps the land that will become the Village, later billing \$11.08 for services

**1891** – Schlafer's Mill (also known as Enterprise Roller Mill) is constructed on the east side of the Menomonee River – this mill operates into the mid-20<sup>th</sup> century and today functions as an office building



**1891** – The Hadfield settlement (named after the adjacent Hadfield Company quarry) appears on a Town of Menomonee plat map – by 1914 maps describe this area as the Lannon

**1891** – A petition in support of Village incorporation is signed by 497 Menomonee Falls residents

**February 3<sup>rd</sup>, 1892** – The Incorporation of the Village of Menomonee Falls is authorized by the order of Judge A. Scott Sloan of the Waukesha County Circuit Court

**March 15<sup>th</sup>, 1892** – By a vote of 103 to 48, residents approve the incorporation of the Village of Menomonee Falls – the Village’s population is estimated at over 500 and the land area is approximately one square mile (including the north half of section ten and the south half of section three from the Town of Menomonee)

In 1892, on the year of the Village’s Incorporation

- Benjamin Harrison is the president of the United States and Grover Cleveland is elected in November
- Ellis Island begins accommodating immigrants to the United States
- The “Pledge of Allegiance” is first recited in American public schools
- General Electric is founded in Schenectady, New York and Thomas Edison patents the two-way telegraph
- The University of Wisconsin develops the first extension courses offered by a state university
- At a YMCA in Springfield, Massachusetts, the first game of basketball is played
- The City of Milwaukee’s population is over 200,000

**1892** –Garwin A. Mace is elected as the first Village president and the first Village Board is established – the first Village Board meetings are held at the Eagle Hotel on Main Street

**1892** – A dozen street lights are purchased and installed in the Village – they are illuminated by kerosene lamps and maintained by two lamp lighters

**1892** – The Mace Lime Kilns close shortly after an employee is killed when he trips and falls into a kiln furnace while unloading a hopper – some sources suggest the closure also resulted from the national financial panic of 1893

**1892** – A lumber yard is built at the north end of the Mill Pond – the yard is soon purchased by Jacob Whittaker (the second Village president) and is eventually acquired by Arthur Jacobson who establishes Jacobson Lumber

**1892** – The Menomonee Hotel is constructed at the southwest corner of the Four Corners by William Minten at a cost of \$8,000 – today the building is occupied by Sal’s Pub and Grill

**1891 – Town of Menomonee Plat Map**

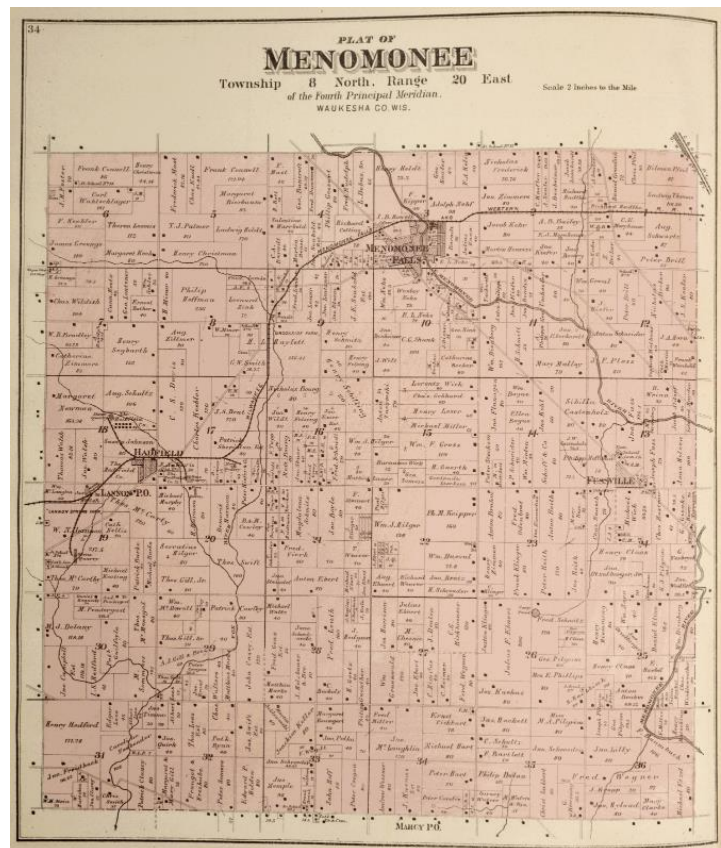

**1892** – The Obermann-Weber block is constructed at the northeast corner of Main Street and Water Street – decades later this building is occupied by Heebie Jeebies restaurant and bar

**1893** – Thomas Hardware is established on Fond du Lac Road (now Appleton Avenue) – a new Thomas Hardware store opens in 1904, and the business operates in the Village until 1962

**1894** – The Menomonee Falls Fire Department is established as a volunteer fire company and begins holding regular practice drills – six of the seven Village Board members are charter members of Fire Company No. 1

**1894** – Albert Mittlstaedt opens the Village’s first barber shop – around the turn of the century, Mittlstaedt charges 25 cents for a haircut and 10 cents for a shave

**1895** – A new large two story public school is completed along Main Street near Hoyt Drive – elementary school classes use the first floor and high school classes use the second floor

**1895** – The Uilein brothers of Milwaukee construct a three story 62 foot tower on the tallest hill in the Town of Menomonee as part of the stock farm of the Schlitz Brewing Company – the tower was razed in the 1920s, but the area where the tower was located along Mill Road is still known as Tower Hill today

**1895** – The Monitor House Hotel is constructed along Water Street

**1895** (some sources say 1898) – The first Fire Department engine house is completed along Fond du Lac Road (now Appleton Avenue) south of Main Street – the building also serves as Menomonee Falls first Village Hall

**1896** – Schmidt Brothers Furniture and Undertaking is established – the Schmidt family continues to operate a funeral home at the corner of Town Hall Road and Menomonee Avenue today

**1895-1896** – The Wisconsin Beet Sugar Company establishes operations at the north end of the Village (on the west side of Water Street north of Roosevelt Drive) – at its peak in the early 20<sup>th</sup> century, the sugar refinery employs 400 seasonal laborers and produces between 15 million and 40 million pounds of sugar annually

**1896** – The Fye Building is completed along Main Street east of Schlafer’s Mill – today this building is occupied by Robin’s Nest clothing store

**1896** – The Order of the Eastern Star is established in Menomonee Falls

**1897** – Francis Waterlin and John Martin begin an ice harvesting industry on the Menomonee River, utilizing the railroad spur which was originally developed to service the Garwin Mace Lime Kilns

**1897** – Klondike Saloon is built on Main Street to the west of the Eagle Hotel – today this building is occupied by Purloin Studio art gallery and coffee shop

**1898** – Local men serve in the Spanish American War

**1899** – Third Street Bridge (later renamed Roosevelt Drive Bridge) is constructed to provide easier access to the rail depot – like many local structures, the bridge is constructed of locally quarried limestone

**1900** – The combined population of the Village of Menomonee Falls and the Town of Menomonee is 2,866 – the Village’s population is 687



**1900s** – Residential construction picks up on the “Eastside” (portions of the Village to the east of the Menomonee River), as four subdivisions are platted adding dozens of new residential lots

**1900s-1930s** – Fair Day is held every third Thursday giving farmers an opportunity to sell and trade livestock, produce and dry goods along Main Street – visitors in this era could treat themselves to a huge portion at Mrs. Blair’s Ice Cream Parlor for 5 cents

**1902** – Menomonee Falls-Hubertus-Holy Hill Telephone Company (later known as the Menomonee Falls Telephone Company) offers the first public telephone service in the Village (the Wisconsin Beet Sugar Company had installed private telephone service a few years earlier) – for several decades thereafter, the limited number of telephone lines are shared between households and businesses

**1902** – Held-Gumm Co. General Store opens in downtown Menomonee Falls

**1902** – Citizens State Bank opens in downtown Menomonee Falls as one of the original occupants of the Fraser Block building (constructed in 1901) at the northwest corner of the Four Corners intersection

**1903** – Emmanuel Evangelical Church builds a large red brick building at the corner of Appleton Avenue and Roosevelt Drive after a windstorm topples the steeple of the original church building

**1903** – The Fussville Post Office closes

**1904** – The Stark Block is constructed on Appleton Avenue adjacent to the Fraser Block – this building is later occupied by Kenny’s Bake Shop and is today occupied by Bradley Realty

**1904** – Schmidt Brothers Furniture store is built on Appleton Avenue south of the Four Corners

**1905** – St. Mary Catholic Parish Church is dedicated on Cleveland Avenue

**1905** – Chicago, Milwaukee, & St. Paul, the Wisconsin Central, and the Chicago & Northwestern rail lines have stops at the Menomonee Falls Depot approximately every 45 minutes

**1905** – A subscription to the Menomonee Falls News costs \$1.50 per year

**1905** – Residential lots are platted along Park Boulevard and the cross streets of Patton Avenue and Harrison Avenue – some homes are constructed prior to World War I, but most of this area is developed in the 1920s

**1906** – Menomonee Falls Public Library is founded on the second floor of the Fraser Block with a collection of 100 books acquired through the Wisconsin Free Library Commission (additional books are purchased via local fundraising campaigns) – Maude Shunk is appointed as the Village’s first librarian

**1907** – A local electric plant offers a lighting alternative to kerosene lamps for the first time – St. Mary Parish is one of the first local organizations to have electric lights installed

**1907** – The Village’s assessed value is \$539,950

**1908** – Farmers and Merchants Bank is established on Main Street

**1909** – The Mace Block is constructed on Main Street

**1910** – The combined population of the Village of Menomonee Falls and the Town of Menomonee is 3,303 – the Village's population is recorded to be 919

**1910s** – The Gettleman Hotel, the Empire Hotel and the Monitor House Hotel provide beds and hot lunches for seasonal laborers at the sugar beet factory

**1910s** – The Village begins installing water mains

**1910** – John Wittlin begins selling Ford cars in a former blacksmith shop on Appleton Avenue – by 1912, Wittlin builds a larger garage on the site and a dozen automobiles are registered in the Village

**1910** – The Chicago Northwestern Railroad bridge is completed at Town Line road near the historic Lannon Springs settlement

**1911** – Adam Gettleman of Gettleman Brewing Company in Milwaukee buys the Wisconsin Beet Sugar Company

**Circa 1910** – Menomonee Falls High School football and basketball teams are formed

**1911** – Dr. G.U. Lyns offers the first dental appointments

**Mid 1910s** – Ray German starts a passenger transportation service for reaching Milwaukee by touring car in 1914 – Jitney buses (with capacity for 10 passengers) replace the touring cars a couple of years later – in 1919 the fare is 55 cents for a round trip to Milwaukee and back

The increasing popularity of automobile services, the improvement of local roads, and the prevalence of personal automobiles leads to the discontinuation of local passenger train service in the 1920s

**1915** – The Campfire Girls club is organized in Menomonee Falls

**1915** – A new concrete bridge is built across the Menomonee River at Main Street

**1915** – The Village budget is \$15,619 – streets and highways account for 42 percent of expenditures

**1916** – St. Mary Catholic Church opens its first parochial school

**1916** – A Wittlin Motors Ford touring car (or convertible car) sells for \$360

**1916** – The first silent films are shown at the Minten Hotel and Tavern which was located on the southwest corner of the Four Corners

**1914 – Town of Menomonee Plat Map**



**1917 – Menomonee Falls celebrates the 25<sup>th</sup> anniversary of its incorporation – the Village’s population is estimated to be 1,000 residents**

In 1917, on the year the Village turns 25:

- Woodrow Wilson is president of the United States
- The United States declares war on Germany, beginning the United States’ involvement in World War I – 120,000 Wisconsin soldiers will serve in the Great War
- *Over There* is a 1917 hit song by George M. Cohan which rose to popularity during World War I
- The State Capitol building is completed in Madison at a cost of \$7.3 million
- Menomonee Falls’ water tower is built along Fond du Lac Road (now Appleton Avenue) – in the following years a car dealership called Klinger Southern Motor Company (later Tower Dodge) opens next to the water tower
- Nine members of the Milwaukee Police Department are killed by a bomb
- The City of Milwaukee’s population is over 400,000
- The Chicago White Sox defeat the New York Giants in the World Series

**1917-1919 – Many local men serve overseas in World War I**

**1918 – Full-width concrete pavement is installed on Main Street and Fond du Lac Road (now Appleton Avenue) for the first time**

**1918 – A severe snow storm buries the Village in two feet of snow – the *Menomonee Falls News* reports that “the country roads are stacked up higher than fences” and that “old timers agree” the storm was the worst since 1881**

**1918 – A.A. Schmidt and Sons Funeral Home uses a motorized hearse for the first time**

**1918 – Wisconsin Beet Sugar Company is sold to Farly Candy Company – the appraised value of the operation is \$1.6 million**

**1918 – The Village celebrates Armistice Day on November 11<sup>th</sup> with bell ringing and a community parade – a routine that will be repeated for many years to come**

**1919 – State Highway 15 is constructed through Menomonee Falls and, by 1922, is completed to Green Bay, creating the longest concrete road in the state – in 1919, Menomonee Falls is said to be the first community in Waukesha County to have an uninterrupted stretch of concrete highway to Milwaukee**

**1919 – A Wisconsin Inspection Bureau report describes the Village as a “thriving agricultural community with small growth from manufacturing industries; large sugar beet factory, small machine shops and flour mills...”**

**1919 – Menomonee Falls High School is destroyed by fire and one boy is killed; the Fire Department is unable to fight the fire effectively due to a lack of water pressure in the hydrants – the fire is suspected to have started due to a leak which allowed sparks to escape the chimney and ignite the attic**

**1919 – 115 automobiles and two trucks are recorded on Village tax rolls**

**1919 – The first ambulance to serve the Village is a customized Ford Model T**

**1919 – Gessert’s General store opens on Main Street – the store, which was known to carry a large selection of toys, years later relocates to the corner of Appleton Avenue and Menomonee Avenue**

**1919-1921** – School classes are held at the St. Paul’s Church Guild Hall and a room in the Stark Building while a new building is constructed

**1920** – The combined population of the Village of Menomonee Falls and the Town of Menomonee is 3,194 – the Village’s population is 1,019

**1920s** – The first generation of businesses serving automobile travelers is developed and three subdivisions are platted adding over 100 new residential lots

**1920s** – A scoop of candy can be purchased from Held’s Cash store for a penny, and children use Third Street (now Roosevelt Drive) as a sledding hill in winter – seven hotels operate in the Village catering to travelers and seasonal workers at the sugar beet factory

**1920** – Citizens State Bank is reorganized due to financial troubles

**1920** – Sterling Service Station opens on east Main Street – today the station’s garage is occupied by R.B. Enterprises

**1920** – Schuman Motor Company Ford Garage opens on Appleton Avenue

**1920** – A severe flood inundates Menomonee Falls as four inches of rain falls in one hour – on the “Day of the Flood” all roads leading out of the Village become impassable rushing rivers

**1920 to 1921** – The Hille Building and Hans Mueller’s Café Buildings are constructed next to one another along Fond du Lac Road (Appleton Avenue) north of the Four Corners

**1921** – Baer’s General Store burns down on the northeast corner of the intersection of Fond du Lac Road and Main Street (the Four Corners) – Held’s Restaurant and Bowling Alley is later built on the site

**1921** – Farmers and Merchants Bank constructs a large new building at the northeast corner of Grand Avenue and Main Street

**1921** – Lincoln School is dedicated as a replacement to the school that burned in 1919 – Menomonee Falls Public Library is housed within the school, and students from kindergarten through high school use the building with some traveling from as far away as Sussex, Jackson and Granville (these areas did not have a high school in the 1920s)

**1922** – Highway 15 is officially dedicated through the Village as a state route between Green Bay and Milwaukee – the highway is part of the Yellowstone Trail which was the first paved transcontinental automobile route (the route extended between Plymouth, Massachusetts and the Puget Sound in Washington State).

**1922** – The first traffic signs are installed at the Four Corners

**1922** – The Land-O-Lakes Baseball League of Waukesha County is organized with Menomonee Falls as one of the original members

**1922** – The Menomonee Falls Woman’s Club is organized to promote “literary, social and philanthropic work along practical lines and aid in the extension of civic improvement” – the club raises over \$1,000 (over seven years) for the public library as their first major project

**1922** – A severe snowstorm strikes Menomonee Falls – snow drifts are dug out by hand to open Highway 15 to Milwaukee

**1923** – Wittlin’s Filling Station and Hickory Grove Tourist Camp is established along north Fond du Lac Road – an example of the tourist cabins constructed in the camp survives within the existing mobile home court that now occupies the site

**1923** – Main Street is designated as State Highway 74 – the street remains a state route until 2016 when it returns to local jurisdiction

**1924** – The Beet Sugar Factory is sold to the Menominee River Sugar Company of Menominee, Michigan

**1924-1925** – Part-time police constables earn \$8 to \$15 per month enforcing local laws in the Village and Town of Menomonee – Otto Schneider begins service as a Town constable in 1927

**1925** – Modern sewer lines are installed from the Four Corners to a sewage outflow into the Menomonee River along Arthur Avenue (an activated sludge treatment plant is later constructed at this site in 1934) – early sewer lines are constructed of clay pipes and are not subject to any testing for water tightness

**1925** – A local resident donates an automobile for use by the police constable

**1925** – County Highway Q and County Highway K open along the northern and southern borders of the Town of Menomonee

**1925** – The first Village well is dug – it is put into operation the next year

**1926** – Highway 74 is paved between Menomonee Falls and the Village of Granville to the east

**1926** – Willow Springs School is built along Town Line Road – the school is later expanded in 1957 and again in 1959

**1927** – Milwaukee Electric Company begins operating a bus line between Menomonee Falls and Milwaukee following their purchase of the local jitney service

**1928** – The Menomonee Falls Rotary Club is chartered as the first men’s service organization in the Village

**1929** – Honey Acres relocates to Menomonee Falls from Milwaukee and begins production of a long line of honey and beeswax products in the Village

**1929** – Lots are platted and infrastructure is installed for new homes along Kenwood Boulevard and Bellevue Boulevard

**1929** – North Hills Country Club is established in Fussville on the site of an old Fuss family farmstead – the clubhouse is completed the following year

**1929** – Methodist Episcopal Church falls on hard times and disbands nearly eight decades after it was established

**1929** – A modern fire alarm siren system is installed in the Village – it was sounds every day at noon until 1983

**1930** – The Village dedicates a new municipal building on Appleton Avenue – the mason work on the building’s façade reads “City Hall” suggesting the aspirations of community leaders – the building houses Village offices, Fire House No. 1 and the Menomonee Falls Public Library

**1930** – The combined population of the Village of Menomonee Falls and the Town of Menomonee is 3,227 – the Village’s population is 1,291

**1930s** – Three subdivisions are platted adding dozens of new residential parcels

**1930s** – The Minten Hotel and Tavern operates on the southwest corner of the Four Corners intersection, Citizens State Bank operates on the northwest corner, Held's Cash store occupies the southeast corner building and the northeast corner was home to Art and Joeck's Standard Oil station – Held's Cash store offers purchases on store credit accounts

**1930s** – Bulletproof glass, sharp steel pointed rods and electrified wires are installed at the Farmers and Merchants bank to deter bank robberies which were common in those days throughout the Midwest

**1930s** – Menomonee Falls Manufacturing Company (later renamed Falls Foundry) and the Dostal-Lowey and Company bottle washer plant operate on east Fourth Street (now Roosevelt Road)

**1930** – The neighboring community of Lannon incorporates as a Village

**1930** – Bast's One Stop Service Station is built in a Spanish Colonial style along Appleton Avenue – in recent years this building has been occupied by George Webb's and Griddler's Cafe

**1932** – The sugar beet factory closes due to financial difficulties after nearly four decades of operation – the machinery is sold to a German business and residents use bricks from the factory for home construction along Pershing Avenue and for an addition to St. Mary Parish School

**1930s-1950s** – Residents enjoy ice skating, hockey and bon fires on the Mill Pond during the winter months

**1930's** – Baer's meat market operates a butcher shop on Main Street

**1932** – The Henrizi-Schneider American Legion Post is chartered and the Legion Post Band is formed

**1933** – The first Boy Scout and Girl Scout Troops are formed in Menomonee Falls

**1933** – Citizens State Bank closes due to financial difficulties during the Great Depression

**1933** – Over 25 percent of Waukesha County's population receives some form of state government relief

**1933** – The Federal government hires 45 unemployed men to complete public works projects throughout the Village – Village Park (1935) and the Village Park band stand (1938) are created using Works Progress Administration funding

**1934** – The machinery in the Jesse Nehs Mill is dismantled after 83 years of mill operations – the building is reused starting in 1939 as Semon's elevator and supermarket

**1935** – The Village's assessed value is \$1.7 million and the tax rate is \$21 per thousand

**1935** – The Menomonee Falls Garden Club is established

**1935** – The lands which are now Village Park are purchased by the Village from the Bernstein family

**1935** – Signage is installed on all Village streets and every house in the Village is numbered to ensure efficient emergency response times – the current address system is adopted in the 1960s

**1935** – The historic Nehs family grandfather clock is donated to the Menomonee Falls Public Library – the clock was built in Pennsylvania around 1800 and is said to have been brought to Menomonee Falls by covered wagon in 1844

**1936** – The Village Board raises wages for snow shoveling crews to 35 cents an hour



**1936** – Fire fighters begin to be trained in administering first aid

**1937** – The Police Department becomes a full-time governmental service with Otto Schneider serving as the Village's only police officer (and Police Chief) – Otto's responsibilities include traffic control, street washing, dog catching and snow plowing along with law enforcement – Otto is alerted to emergencies with a red light on top of the Fraser Building at the Four Corners – this alert system continues until the 1960s

**1937** – The Menomonee, Granville and Germantown Insurance Company is renamed the Menomonee Town Insurance Company

**1937-1938** – Hiawatha Heights is developed by Jacobson Lumber Company becoming the first FHA approved subdivision in Wisconsin and expanding the footprint of the Village with dozens of new single family homes – new homes sell for approximately \$4,000 to \$5,000

**1938** – Grace Evangelical Lutheran Church (now St. John the Apostle Parish) is built on Main Street

**1939** – The Lepper Dam fails when an attempt at dynamiting an ice jam goes awry – the Mill Pond is drained

**1939** – The American Legion flagpole memorial is constructed in Village Park

**1939** – The first high school marching band is organized and a visit to the movie theater cost as little as 10 cents

**1939** – The Public Works Department is comprised of one truck and two men and the Village develops its first guidelines for building inspection

**1940** – The combined population of the Village of Menomonee Falls and the Town of Menomonee is 3,674 – the Village's population is 1,469

**1940** – A fall festival is held in Menomonee Falls through the sponsorship of local business leaders who are determined to show everyone a good time "without costing a penny" – over 6,000 people reportedly attend the event

**1940s** – The Village begins a two decade transformation into a suburban bedroom community as the Post-War housing boom accelerates residential development – 5 subdivisions are platted adding roughly 200 residential parcels

**1940s** – The Menomonee Town Hall is relocated to north side of Good Hope Road – this is the present site of the Village of Menomonee Falls public works facility

**1940** – The Menomonee Falls Chamber of Commerce is founded with the mission of improving the industrial, commercial and civic well-being of the community

**1940** – The first Brownie Troop is organized in Menomonee Falls

**1941** – The Falls Theater opens on Appleton Avenue replacing a wooden theater that burned down in 1940

**1941** – A.A. Schmidt & Sons builds a new funeral home on the northeast corner of Third Street (now Roosevelt Drive) and Appleton Avenue

**1941** – Following the Japanese bombing of Pearl Harbor, the United States enters World War II – young men from many local families serve in the conflict which continues until 1945

**1942 – Menomonee Falls celebrates the 50<sup>th</sup> anniversary of its incorporation – the Village’s population is estimated at 1,700**

In 1942, on the year the Village turns 50:

- Franklin D. Roosevelt is President of the United States
- The United States is at war against the Axis Powers in the Pacific and Europe following the Japanese bombing of Pearl Harbor in December 1941 – Wisconsin sends 375,000 soldiers to war
- The Village Board passes an ordinance requiring residents to observe blackout regulations – covering windows and turning off lights to save energy and to make the community less visible for potential air attacks
- Sales of new cars are banned to save steel and gasoline is rationed
- The Village hosts a “Salvage for Victory” parade as a means for area farmers to donate scrap metal and other salvageable goods
- Residents contribute to the war effort through factory work, paper drives, rationing and victory gardens
- With many players serving in the war effort and blackout restrictions limiting travel and night games, the 1942 Major League Baseball season is nearly cancelled
- *Moonlight Cocktail* by the Glenn Miller Orchestra tops the Billboard Charts
- Wisconsin Governor-Elect O.S. Loomis dies and Lt. Governor Walter Goodland is appointed as acting governor
- The City of Milwaukee’s population approaches 600,000

**1942-1945 – The Fire Department conducts regular air raid drills in the Village of Menomonee Falls**

**1943 – Menomonee Falls Recreation Department is founded with the motto of “Recreation for All”**

**1943 – 37 one acre lots are subdivided from the Thoennes farm on the south side of Good Hope Road – this residential subdivision is among the first recorded in the southern half of the Town of Menomonee**

**1945 – The Village’s assessed value is \$2.4 million and the tax rate is \$30 per thousand**

**1945 – Roman Neu transitions from builder to supplier by opening Neu’s Building Center, which remains in business today along Falls Parkway**

**1945 – Bloomberg leather products plant is established – the plant employs over 100 people at a time when only a handful of manufacturing firms operated in the Village**

**1945 – Church bells ring and fire sirens blare when news of the Japanese surrender comes to the Village – people take to the streets to celebrate by honking car horns and dancing at the Four Corners intersection which is roped off for the occasion**

**1946 – Held’s Restaurant and Bowling Alley is destroyed by a gas explosion – the power of the blast rocks the Caesar’s Plumbing and Heating building from its foundation and blows out windows throughout the downtown area**

**1946 – The Walter Miller Amvet Post #5 is organized in the Village – the Post buys and renovates the former Wisconsin Sugar Company offices on Water Street as a club house (today the building serves as a club house for the Knights of Columbus)**

**1946 – The Menomonee Falls Lions Club is founded with the goal of community service of all kinds and a priority for aid to the visually handicapped**

**1947** – Hiawatha Shopping Center becomes the first shopping area with off-street parking in the state – it is occupied by Kahn’s Department Store, A&P grocery and later Held’s Recreation and Bowling Alley (tenants today include Pop’s Frozen Custard and Krueger’s Entertainment Center)

**1947** – The Menomonee Falls Post Office begins home mail delivery

**1947** – Lohmiller’s Drug Store opens on the southeast corner of Appleton Avenue and Main Street – this building was the former location of Wegner’s Drug Store and the future location of Nino’s Italian Bakery & Deli

**1947** – Wittlin’s Cabin Camp is sold and converted into a mobile home court

**1947** – A World War II Memorial is built in Village Park by Walter Miller Amvet Post #5

**1947** – A round trip between the Village and downtown Milwaukee costs 54 cents on the Greyhound bus

**1947-1948** – St. Mary Catholic Parish School is rebuilt to make room for more students

**1948** – Construction begins on a new Menomonee Falls High School building along Garfield Drive

**1949** – The Menomonee Falls High School Band Revue is held for the first time

**1949** – The School District of Menomonee Falls has a total of 725 students

**Late 1940s-Early 1950s** – the Village acquires lands around the Mill Pond for use as a community park

**1950** – The Korean War begins and many local young men serve in the conflict – the war continues until early 1955

**1950** – The combined population of the Village of Menomonee Falls and the Town of Menomonee is 6,262 (a 70 percent increase from 1940) – the Village’s population is 2,469

**1950s** – The Village of Menomonee Falls and the Town of Menomonee rapidly change by way of suburban style residential development – 101 subdivisions and over 4,500 residential lots are platted within the Village and Town of Menomonee and their combined population increases by nearly 12,000 residents

**1950s** – Diesel engines replace steam locomotives on local railroad tracks, Rivercourt Shopping Center opens along Highway 41, Kenny’s Bakeshop operates on Appleton Avenue and residents enjoy drive-in movies at the Starlite and Victory drive-in theaters

**1950s** – A feasibility study determines that there are only six doctors practicing within the Village and Town of Menomonee and recommends the creation of a community hospital

**1950s** – The combined assessed value for the Town of Menomonee and the Village of Menomonee Falls increases from \$18.2 million in 1950 to \$100.9 million in 1960

**1950** – The Lincoln Lodge of Free and Accepted Masons builds a Masonic Temple at the intersection of Main Street and Sheridan Drive

**1950** – The Menomonee Falls Post Office occupies the Mace Block on Main Street adjacent to Lohmiller’s Drug Store

**1951** – Stolper Steel Products opens a plant and office in Menomonee Falls along Roosevelt Road employing upwards of 400 people

**1951** – The first wing of a new High School building off Garfield Drive is completed – additions are incorporated in the following decade to accommodate the rapidly growing student body

**1951** – Holy Cross Lutheran Church begins meeting

**1952-1953** – St. Mary Convent is dedicated and the church is enlarged to accommodate a growing congregation

**1952** – A new sewage treatment plant (of the trickling filter type) is constructed along the Menomonee River Parkway east of Pilgrim Road

**1953** – US 41 (now Interstate 41) is completed to the northeast of the Village of Menomonee Falls – the old Highway 41 (now Appleton Avenue) is designated as State Trunk Highway 175

**1953** – Home construction begins in the Walterwood subdivision

**1953-1954** – The dam and landscape along the Mill Pond are restored – residents donate cash (\$5,000), labor, and materials and the Garden Club and Junior Women’s Club provide assistance in restoring and beautifying the area

**1953** – The McLario Law firm is established on Main Street – the firm continues to operate 64 years later as the McLario, Helm, Bertling & Spiegel law office

**1953** – St. Francis Episcopal Church is founded at the corner of Menomonee Avenue and Laverne Avenue – when the congregation constructs a larger building on the site in 1959, the older building is used for Sunday school until it burns down in 1963

**1953** – St. Anthony Catholic School is rebuilt to modern standards at a cost of \$130,000 – nine additional classrooms are added in 1959 and the structure remains in use today

**1953** – St. James Catholic School opens its doors on Town Line Road

**1954** – The lands which will later become Lime Kiln Park are purchased by the Village

**1955** – A modern fire rescue truck is put into service – the truck is funded through donations from the Lions Club

**1955** – Riverside Park is established along Pilgrim Road

**1955** – Home construction begins in the Forest River subdivision

**1955** – The Village’s assessed valuation is \$11.1 million and the tax rate is \$28.85 per thousand

**1956** – Local newspapers publish a report that the governments for the Town of Menomonee and the Village of Lannon had approved a merger of the two communities – a “minuteman” group forms to circulate petitions to force a referendum on the matter, and the referendum fails in the Town of Menomonee

**1956** – 26 new residential subdivisions are platted in the Village of Menomonee Falls and the Town of Menomonee (the most ever in a single year)

**1956** – The Kiwanis Club of Menomonee Falls is organized – the club continues to serve the Village today through scholarships, scouting and charitable donations to local organizations

**1956** – The Knights of Columbus “All Saints” council is established

**1956** – The Bert Phillips Ballroom (now the Schwabenhof) burns with flames estimated to be 100 feet tall

**1956** – Fire Department members receive pay for their services at a rate of \$2 for the first hour and \$1 for each additional hour at a fire call

**1956** – St. Paul's Church builds a large addition

**1956** – Home construction begins in the Claremore, Emerald Hills, Fair Oak Manor and Bruceton Manor subdivisions

**1956** – With Cold War anxieties running high, the Federal government installs several NIKE missile sites in the Milwaukee area including one along Menomonee Avenue in the northwest area of the Village – this site is deactivated in 1961

**1956-1958** – Oakwood School District, North Hills (Fussville) School District, and Sunnyside School District merge with the School District of Menomonee Falls

**1957** – Jehovah's Witnesses Kingdom Hall opens on Hampton Avenue in the south end of the Town of Menomonee

**1957** – Calvary Baptist Church is founded – starting in 1959, the congregation meets at a small white church building on Main Street which was originally occupied by Grace Evangelical Lutheran Church

**1957** – The School District of Menomonee Falls has a total of 2,146 students – this represented a threefold increase from the total in 1949

**1957** – Construction of Hiawatha Elementary School begins along Menomonee Avenue

**1957** – Home construction begins in the Good Hope, Silver Spring Heights, Shady Lane, North Hills Manor, Community Hills, Country Lanes, Hillside Spring Estates, Silver Spring Meadows, Normandale and Menomonee Manor subdivisions

**1957** – The newly elected Town Board commissions a report from the University of Wisconsin to study the Town of Menomonee's governmental organization and offer recommendations – the study, dated October 1, recommends (citing major fiscal challenges and local service shortcomings) that the Town of Menomonee merge with either the City of Milwaukee or the Village of Menomonee Falls

**1957** – Findings from the report on *Governmental Organization for the Town of Menomonee* include:

- The combined population of the Town and the Village is estimated to be nearly 14,000
- The population of the Town increased by 279 percent (adding over 6,000 new residents) between 1940 and 1957 and 1,258 permits for single family homes were issued between 1950 and 1956
- 1,000 new Town residents are to be expected per year into the early 1960s and the area will support upwards of 30,000 residents according to the existing Town zoning code
- The street miles maintained by the Town increased by 112 percent from 33 to 70 between 1953 and 1957
- A number local service shortcomings exist including the Town of Menomonee's inadequate police force (the Town employed 3 part-time police officers for a population of over 8,300 residents)
- Major public service challenges will exist regardless of the future form of government
- Merger with either the City of Milwaukee or Village of Menomonee Falls should be pursued

**1957** – The Town Board for the Town of Menomonee votes 2-1 to incorporate as a Fourth class city, Herb Gross (the dissenting board member) resigns and works with the Village of Menomonee Falls to approve and publish an annexation prior to the public posting of the Town Board's decision

**1958** – In a summer Village referendum, residents vote 579 to 289 in favor of annexing the Town of Menomonee

**1958 – Starting in October, the Village of Menomonee Falls annexes the Town of Menomonee** (through a total of six annexations in 91 days), enlarging the land area from roughly two square miles to 32 square miles and increasing the population from 4,500 to at least 14,000 residents – the Village annexes the entire Town, except for the previously incorporated Villages of Lannon and Butler and becomes the fourth largest municipality in the state by land area

**1958** – Good Shepherd Catholic Church is dedicated along Christman Road – a parochial school opens on the site in 1959

**1958** – A station wagon is used for ambulance service – the ambulance operates out of Schmidt Funeral Home and injured residents are taken to see local doctors or transported to Waukesha General Hospital

**1958** – An eight room addition is completed at the Lincoln School on Main Street

**1958** – Home construction begins in the Shepherd Hill, Hoyt Highlands, Hiawatha Estates, Menomonee Parkway, Winchester Highlands and Royal Manor subdivisions

**1958** – The former Menomonee Town Hall along Good Hope Road becomes the Village Hall – the building later houses the Village's Public Works Department

**1958** – Menomonee Falls Telephone Company is sold to Wisconsin Bell

**1959** – The Village commissions a consulting firm to prepare a report about changing from village to city status – the report recommends that Menomonee Falls become a city

**1959** – Nor-X Way Industrial Park opens north of US 41 (now Interstate 41/US 45)

**1959** – Grace Evangelical Lutheran Church relocates to a modern brick building on Kenwood Boulevard – day school is offered at the site starting in 1963

**1959** – Emmanuel Evangelical Church (Emmanuel Community Church) relocates to a modern building on Menomonee Avenue – the old red brick church is demolished in 1960 – before the move, some church services are televised by WTMJ with the old church's hilltop location being ideal for reception

### 1959 – Community Facilities in the Village of Menomonee Falls

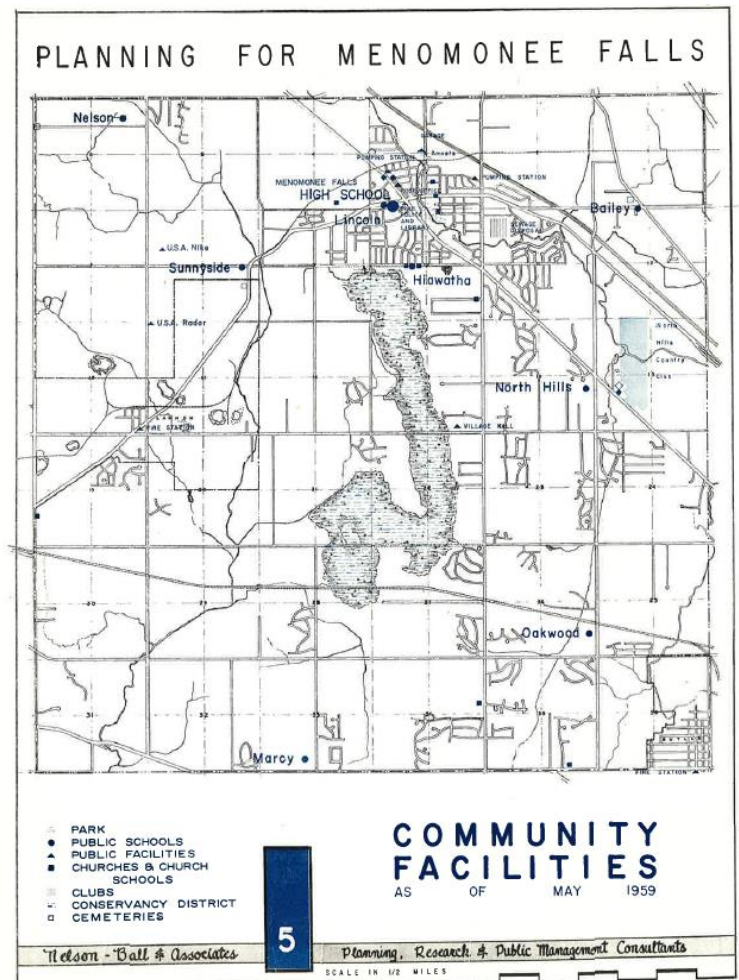

**1959** – An estimated 4,000 people move to Menomonee Falls and public school enrollment increases by 29 percent in one year – it was said that for a period in the 1950s and early 1960s that the School District of Menomonee Falls is the fastest growing school district in the nation



**1959** – The Village imposes a minimum lot size of 10,000 square feet and requires a \$200 contribution (impact fee) from developers for schools and recreation facilities

**1959** – Most new homes in the Village are priced between \$15,000 and \$20,000

**1959** – Riverside Elementary School opens along Margaret Road on the east side of the Village

**1959** – Home construction begins in the Devonwood and Arrowhead Range subdivisions

**Late 1950s** – First, Second, Third and Fourth Streets (all located to the northeast of the Four Corners) are renamed to Grant Street, Cleveland Avenue, Roosevelt Drive and Pershing Avenue

**1960** – The population of the Village of Menomonee Falls is 18,276 – the average household size is 3.9 and 48 percent of the population is 19 years old or under – men make up 75 percent of the workforce

**1960s** – The Village welcomes over 13,400 new residents (a 73 percent increase) and 21 subdivisions are platted adding nearly 2,000 residential lots

**1960s** – The school districts build six new schools and an indoor swimming pool to accommodate the influx of children – the Menomonee Falls School District projects it will need a third high school by 1975

**1960s** – Residents enjoy an annual series of outdoor patio concerts in front of the Menomonee Falls High School (now North Middle School), and other community activities include an all-Village track meet, basketball, ice skating, dance lessons, movies and evening education classes for adults

**1960s** – The Village’s first McDonald’s restaurant opens on Appleton Avenue – hamburgers cost 15 cents

**1960** – *A General Plan for Community Development* is drafted as the first master plan for the Village – the plan recommends limitation of residential growth and an increased ratio of commercial and industrial development to allow for more fiscal stability and effective provision of public services – The plan recommends that the Village’s population be limited to 60,000 by 1976 and recommends the creation of a north to south freeway in the western area of the Village – the plan also proposes the conversion of Main Street and Appleton Avenue business district into a pedestrian mall surrounded by surface parking lots

**1960** – An estimated 61 percent of Village residents work in Milwaukee

**1960** – A new Zoning Ordinance is adopted by the Village Board

**1960** – The Pilgrim Village Shopping Center opens at the corner of Pilgrim Road and Main Street – at the time of its completion, it is the seventh largest shopping center in Greater Milwaukee – Jerry’s Village Inn Restaurant (now occupied by DeMarini’s Pizzeria) opens down the street around the same time

**1960** – Holy Cross Lutheran Church is built at Robinhood Drive and Pilgrim Road

**1960** – Pilgrim Lutheran Church and day school open on Bette Drive

**1960** – The Community League of Menomonee Falls is organized with the aim of community service within the Village – the League is started as an overflow of the Newcomers Club

**1960** – Home construction begins in the Parkway Drive Heights and Chateau Park subdivisions

**1960** – Maude Shunk retires her library duties after 54 years of service to the Village

**1961** – The 220 foot chimney stack at the former sugar beet refinery is demolished

**1961** – Home construction begins in the Charlton Heights subdivision

**1961** – Prince of Peace Lutheran Church is dedicated at the corner of Pilgrim Road and Good Hope Road – the congregation initially uses space at the Good Hope Village Hall for worship services

**1961** – Independent Baptist Church is dedicated

**1961** – The Village hires three full-time police officers (at \$400 per month) and operates with one police squad car – the Police Department utilizes the same building on Appleton Avenue which houses the Village Hall, the Fire Department and the Library

**1961** – The United States begins deploying troops in a conflict which later became known as the Vietnam – many local young men serve in the conflict which continues until 1975

**1961** – Dial-up telephone service replaces the local manually operated telephone system in portions of the Village

**1962** – Colonial Plaza shopping center is completed on Appleton Avenue

**1962** – Rotary Park is donated to the Village by the Walter Diehnelt Family and Willowood Park is purchased by the Village from Sid Dwyer & Associates

**1962** – Bethlehem Evangelical Lutheran Church and opens along Menomonee Avenue east of Pilgrim Road – a day school is dedicated at the site in 1965

**1962** – There are approximately 650 business and 6,800 residential telephone subscribers in the Village 60 years after the first public telephone lines were installed

**1962** – A modern Menomonee Falls Post Office is completed along Appleton Avenue at the site of Koch's Dairy farm which had closed following the adoption of a state law requiring pasteurization equipment

**1962** – Trenary Field opens with major league proportions and seating for 400 spectators

**1962** – Hamilton High School opens with a capacity for 3,000 students

**1962** – Menomonee Falls High School hosts the state swimming meet at the school's new indoor pool

**1963** – Urban land uses occupy about 29 percent of the Village's land area

**1962** – The Village's equalized tax rate of \$20.43 per \$1,000 is among the lowest of any incorporated communities in the Greater Milwaukee area

**1963** – Between 400 and 500 babies are added to the population each year and over 1,500 new residents move to the Village annually – the population is estimated at 24,000 five years after the Town of Menomonee was annexed

**1963** – The Guild Hall and parsonage buildings are torn down and a new church school addition is constructed at St. Paul's Church on Appleton Avenue

**1963** – Bob Wolf is the top high school basketball scorer in Wisconsin with 29.5 points per game his senior year – he goes on to star on Marquette’s basketball team

**1963** – The Village Board commissions a study regarding whether the Village should become a city – the report identifies increased transportation funding and government representation as benefits to becoming a city

**1963** – Falls Bible Church is dedicated along Pilgrim Road

**1963** – Thomas Jefferson School is constructed along Laverne Avenue

**1963-1964** – The historic Jesse Nehs Mill Building is torn down for a reconstruction of Farmers and Merchants bank – areas adjacent to the new bank along the Mill Pond are landscaped into a parkway

**1964** – In a Village-wide referendum (with 81 percent voter turnout) residents turn down a proposal for Menomonee Falls to become a city

**1964** – 31 miles of sanitary lines and 2.5 miles of storm water lines have been installed in the Village, and the Village maintains 122 miles of local streets

**1964** – Community Memorial Hospital opens on Town Hall Road with 61 beds – \$650,000 had been raised for the hospital through a local fundraising drive and \$1,000,000 in additional funding was granted by the federal government

**1964** – The Hospital Auxiliary volunteer organization is formed to serve patients at the new hospital – women in the group are known as the “Pink Ladies” and 16 to 19 year-old volunteers are dubbed the “Candy Strippers”

**1964** – Bradley Corporation constructs its headquarters along Fountain Boulevard – today Bradley Corporation remains one of the Village’s largest employers today

**1964** – A Kohl’s store opens at the corner of Appleton Avenue and Pilgrim Road – today this building is occupied by O’Reilly Auto Parts and Dollar Tree

**1964** – Benjamin Franklin Elementary School is constructed to the southeast of the Winchester Highlands subdivision

**1964** – 75 years after its founding, the daily circulation of the *Menomonee Falls News* is over 6,000

**1965** – The Village enters into an agreement with the Milwaukee Metropolitan Sewerage District (MMSD) to provide for the connection of the Village sanitary sewer within the Menomonee River Basin to the MMSD system – due to an intergovernmental disagreement, the first connection is not made until 1971 and full service is not provided to these areas of the Village until 1981

**1965** – PDQ grocery (now Karl’s Country Market) opens along Pilgrim Road in southern Menomonee Falls – 52 years later, Karl’s continues to serve the grocery needs of the Village

**1965** – Otto Schneider retires after 38 years of law enforcement in the Village (Otto had also served as the Assistant Fire Chief and the Director of the Public Works) – a commemoration plaque honors Otto Schneider at the former Fire Station No. 1 – toward the end of his tenure, Otto is quoted to have said “Crime hasn’t increased in the Falls area, except in direct proportion to the population growth”

**1965** – Hope United Church of Christ is dedicated

**1965** – Home construction begins in the Longwood Hills subdivision

**1965** – Lime Kiln Park is established – the Garden Club, Historical Society, and Junior Women’s Club lead the beautification and restoration efforts

**1965** – The Village acquires the Miller-Davidson home and farmstead at the corner of County Line Road and Pilgrim Road – today this is the site of Old Falls Village historical park

**1966** – The Falls Patio Players theater group is formed – the group stages performances at Menomonee Falls High School (now North Middle School)

**1966** – WZMF takes to the airwaves as the Village’s local radio station

**1966** – Construction of Valley View Elementary School begins along Town Hall Road

**1966** – The first local YMCA opens its doors to the public

**1966** – Gloria Dei Lutheran Church was established on Town Hall Road south of Custer Lane

**1966** – The Menomonee Falls Branch of the American Association of University Women is established

**1966** – The Menomonee Falls Historical Society is established by charter from the State Historical Society of Wisconsin

**1966** – The Eirenicon Club is founded as a social club for senior citizens in Menomonee Falls

**1966** – Ernie von Schledorn opens a car dealership on Main Street east of Pilgrim Road

**1966** – Sixty years after its establishment, the municipal Maude Shunk Free Library has an annual circulation of over 125,000

**1966-1967** – A new Village Hall and Public Library are constructed on Pilgrim Road north of Menomonee Avenue at a cost of \$1.4 million – the new complex houses municipal offices, Village Board chambers, the municipal court and the Police Department

**1967** – **Menomonee Falls celebrates the 75<sup>th</sup> anniversary of its incorporation with a population estimated at 33,000 – which marks the first population peak in Village history**

In 1967, on the year the Village turns 75:

- Lyndon B. Johnson is President of the United States
- The Vietnam War is escalating, protests occur on University of Wisconsin campuses
- The Green Bay Packers defeat the Kansas City Chiefs in the first Super Bowl
- Milwaukee is without a professional baseball team as the Braves moved to Atlanta in 1966 and the Brewers were not established until 1970
- *To Sir With Love* by Lulu tops the Billboard Charts
- The City of Milwaukee’s population exceeds 700,000
- Race riots rock Milwaukee
- The Diamond Jubilee celebration brings together residents from all over the community to celebrate the history and progress made in the Village since its founding – hundreds of residents dress in 1890s era clothing and participate in a week of festivities

**1967** – The Police Department has 38 officers and the Volunteer Fire Department consists of 41 members – the departments are described to be “of a standard of which any community could be justly proud”

**1967** – There are two traffic controlled intersections in the Village – one is at the Four Corners and the other is at the intersection of Appleton Avenue and Pilgrim Road

**1967** – Menomonee Falls’ Village Board adopts an open housing ordinance to ensure equal housing opportunity for all people

**1967** – Falls Presbyterian Church opens along Pilgrim Road

**1967** – The equalized value of the Village has doubled since 1963

**1967-1969** – Municipal Park is developed to the east of the new Village Hall and Library

**1968** – The area which is now Rivers Edge Park is donated to the Village by Mr. and Mrs. Donald Stroh

**1968** – The Schwabenhof, a German social club located along Silver Spring Drive, opens its doors to the public for German-style banquets, old-world fried chicken and fish fry – the Schwabenhof continues to operate nearly 50 years later

**1968** – Roughly 2,200 students attended Menomonee Falls High School – the building later becomes North High School and then North Middle School

**1969** – Enrollment in the School District of Menomonee Falls is over 10,000 and the new Menomonee Falls East High School opens on Merrimac Drive – Land is acquired for a potential third high school (Menomonee Falls South High School) along Mill Road

**1969** – A road widening project along Appleton Avenue/State Trunk Highway 175 destroys most of the historic buildings in the Fussville settlement – property owners are forced to sell their parcels at fair market value per the legal standards established for eminent domain takings

**1969** – Waukesha County identifies several reasons to preserve and protect the Tamarack wetland area including the benefits of groundwater recharge, stormwater retention and maintenance of habitat for many plant and animal species

**1969** – Oakwood Elementary School closes on Lilly Road

**1969** – Zion Lutheran School opens on Lisbon Road

**1969** – A new sewage treatment plant is dedicated at the current site of Rivers Edge Park – by 1975, an estimated 20 percent of Village homes are connected to centralized sewer service – limited access to centralized sewer service limits new development and population growth during the 1970s and 1980s

**1970** – The population of the Village of Menomonee Falls is 31,697 (a 400 percent increase since 1950) – men make up 66 percent of the workforce, residents are most likely to work in the manufacturing industry and the average household size is 4.0

**1970** – Village Green apartment complex is constructed along Town Hall Road

**1970s** – The Village’s growth trend is reversed as Menomonee Falls’ population declines by 12 percent (over 3,800 residents) despite seven new residential subdivisions being platted

**1970s** – Kiwanis Park is acquired and developed through a partnership between the Village and the Kiwanis club

**1970** – Approximately 12 percent of the Village’s total land area is sewerred as the Village continues to pursue connections to the Milwaukee Metropolitan Sewerage District

**1970** – North Hills Elementary School closes on Lilly Road and Bailey Elementary School closes on Main Street – North Hills Elementary School is repurposed as the School District of Menomonee Falls’ central office

**1971** – The Vince Lombardi Golf Classic starts at North Hills Country Club – it will become the largest two day charity golf event in the country

**1971** – Menomonee Falls North High School wins the boys cross country state championship – they repeat as champions in 1976 and 1982

**1972** – Village Police squad cars are equipped with air conditioning for the first time

**1972** – The first full-time salaried fire chief is hired

**1972** – Wittlin’s Service becomes the first self-service gas station in Menomonee Falls

**1972** – There are an estimated 9,200 jobs in the Village

**1972** – Old Falls Village is officially named by the Historical Society

**1973** – The Village Board creates a Preservation of the Tamarack Swamp Committee which focuses on acquisition of the wetland into local public ownership – large portions of the Tamarack Preserve are donated by developers (the Village owned just 33 acres in 1973 and now owns over 700 acres of this wetland area)

**1973** – The Falls Theater on Appleton Avenue is closed and torn down – the Village’s two drive-in theaters and another theater operating in the Pilgrim Village shopping center provide entertainment alternatives

**1973** – The Village commissions a study and redevelopment plan for Menomonee Falls’ downtown to address traffic/parking concerns and promote revitalization of the central business district – the plan envisions the razing and reconstruction of dozens of homes and businesses for a modern shopping and residential center with hundreds of off-street parking spaces

**1973** – A new Zoning Ordinance is adopted by the Village Board – this ordinance provides the foundation for the Zoning Code the Village follows today

**1973** – Falls Baptist Church is dedicated along south Appleton Avenue

**1973** – A major snowstorm shuts down the Village – it is said to be the largest snow event since 1922

**1973** – The Optimist Club is established

**1974** – The old Menomonee Falls Railroad Depot is relocated to Old Falls Village historical park

**1974** – Harvey Moy’s Chinese Restaurant opens on Appleton Avenue

**1975** – The Village adopts the *1973 Menomonee Falls Master Plan Study* – the plan envisions that the Village’s population will ultimately reach between 125,000 and 150,000 persons – the transportation system portion of the plan



proposes the construction of two freeways and five interchanges in the southern and western areas of Menomonee Falls by 1990

**1975** – A second fire station is constructed on Silver Spring Drive adjacent to Willowood Park

**1975** – North Point Centre shopping area opens along Appleton Avenue

**1975** – Children’s Community Center is founded along Christman Road

**1975** – A new industrial park is established and promoted by the Village to the north of US 41/45 along Fountain Boulevard

**1976** – Lincoln Elementary School closes on Main Street

**1976** – Two full-time firefighters are hired, complementing the volunteer companies – over the years additional full-time firefighters are hired, but the Fire Department remains a combination force today

**1976** – Home construction begins in the Georgetown West subdivision

**1976** – Menomonee Falls East High School wins the state football championship

**1977** – The Fire Department begins to provide emergency medical service within the Village

**1977** – Home construction begins in the Tamarack Hills subdivision

**1977** – Police Officer John Taylor is killed in the line of duty – John Taylor Park (located along Appleton Avenue) is dedicated in 1982 as a visible honor to his sacrifice

**1977** – The last train runs between Merton and Menomonee Falls on the Bug Line – removal of the rails and ties begins in 1978 – today, the 16 mile rail corridor has been repurposed as the Bug Line Recreational Trail

**1978** – The *1973 Village of Menomonee Falls Master Plan* is amended to remove proposed freeway extensions through the southern and western portions of the Village

**1978** – There is only one new home built in the School District of Menomonee Falls

**1978** – Ernie von Schledorn opens a new auto sales campus on Main Street east of US 41/US45

**1978** – An expansion at Community Memorial Hospital doubles the size of the facility

**1979** – There are 59 police officers working for the Village

**1979** – Pepino’s Pizzeria opens on Appleton Avenue

**1979** – Menomonee Falls East High School wins the state softball championship

**1980** – The population of the Village of Menomonee Falls is 27,845 – median housing value is \$68,400 and median gross rent is \$239 per month – men make up 58 percent of the workforce

**1980** – The median age of residents in the Village is 31.1 years and nearly 35 percent of residents are 19 and under – the average household size is 3.2

**1980s** – The Village’s population continues to decline (due to smaller household sizes) despite 16 new residential subdivisions adding nearly 1,000 new residential lots

**1980s** – Wacker Neuson Corporation builds a manufacturing facility on Anthony Drive

**1980s** – Strong Capital Management builds a corporate campus adjacent to North Hills Country Club as part of the Heritage Reserve Corporate Park – today the site is utilized by Wells Fargo

**1980** – 31 percent of the working age population reported employment within the Village and the manufacturing industry continues to be the leading employment sector

**1980** – The Village adopts its first *Comprehensive Plan for Parks and Recreation* – a plan which has been updated five times since as the *Comprehensive Outdoor Recreation (COR) Plan*

**1980** – Menomonee Falls High School industrial arts classes build a gazebo at Old Falls Village historical park

**1980** – A third fire station is constructed on the site of the former North Hills School on Lilly Road south of Appleton Avenue

**1980** – The River Bluff apartments are constructed across from Village Hall

**1980** – The Wisconsin DOT paves over the at-grade railroad crossing at US 41/45

**1980** – Harley Davidson opens a motorcycle powertrain factory along Pilgrim Road and US 41/45 in northern Menomonee Falls

**1980** – The Menomonee Falls railroad depot is relocated and rededicated as part of Old Falls Village historical park

**1981** – Arandell Corporation builds a plant in Menomonee Falls – the facility eventually grows to over 250,000 square feet in size and Arandell becomes one of the largest employers in the Village

**1982** – The Garwin Mace Lime Kilns are listed on the National Register of Historic Places – over 20 additional Village sites added to the National Register of Historic Places during the 1980s

**1982** – Falls Cable Access is formed – today the channel continues to operate out of a studio in Menomonee Falls High School with franchise fees paid by Time Warner Incorporated

**1983** – Hiawatha Elementary School closes on Menomonee Avenue – the building is repurposed as the School District’s central offices

**1983** – Fire destroys Westbrook Lanes causing in excess of \$1,000,000 in damages

**1983** – The Menomonee Falls Food Pantry is established with the support of twelve local churches – today the pantry operates out of the former Village Water Department building on Menomonee River Parkway

**1983** – The Greater Menomonee Falls Committee forms to create a new vision for downtown

**1984** – Menomonee Falls North and East High Schools merge into one due to declining enrollment – student groups from the schools agreed upon the mascot and school colors for the combined campus

**1984** – Magnetek Incorporated is founded in Menomonee Falls – today the company has campus with multiple buildings in the Falls Business Park along Lilly Road

**1984** – Falls Baptist Church Academy opens along south Appleton Avenue

**1985** – Industrial businesses utilize over twice the land area than they did in 1965 – reflecting the Village’s transition from bedroom community to regional job center – an estimated 15,800 jobs are found in the Village in 1985

**1985** – The Village works with the Chamber of Commerce to conduct a business retention survey – businesses indicate a continued need for developable industrial parcels

**1985** – Urban land uses occupy about 38 percent of the Village’s land area

**1985** – St. John the Apostle Anglican Catholic Church is dedicated on east Main Street

**1986** – The first large retail stores open at the intersection of County Line Road and Appleton Avenue

**1986** – A portion of the Village is connected to the City of Brookfield sewerage system – the Village later makes sewer connections with the Villages of Sussex, Germantown, Butler and Lannon

**1986-1987** – Nine new subdivisions are approved resulting in over 800 new single family home lots

**1987** – The Village’s Overall Economic Development Program Plan (OEDP) indicates a structural shift from manufacturing to service industry employment in the Village and the region

**1987** – The Village begins work to extend sanitary sewer service to the Lilly Creek area

**1987** – Home construction begins in the Pheasant Hills and Hunters Ridge subdivisions

**1988** – The old Village water tower on north Appleton Avenue is dismantled – a new water tower is built about a half mile to the northwest in the early 1990s

**1988** – Falls Business Park, located along Lilly Road near Hampton Avenue, is the first location in the Village to utilize Tax Increment Financing (TIF) for infrastructure in order to promote private investment and ultimately raise property values – this TIF District is paid off in 1996

**1988** – The Community Development Authority (CDA) is organized to encourage and help people and businesses to invest in the Village to create jobs, tax base and improve the community’s quality of life

**1988** – A report prepared by the Downtown Revitalization Committee calls for rehabilitation of the Mill Pond and clearing of the tangled brush blocking the view of the dam from Main Street

**1989** – At its 25<sup>th</sup> anniversary, Community Memorial Hospital has grown to 131 beds, 24 nursery basins, nine cardiac beds and 29 special surgical beds

**1989** – Lincoln School is torn down and regraded as a soccer field

**1989** – Village lands located to the east of the Menomonee River are annexed by the City of Milwaukee as part of an agreement to extend Milwaukee water service to Menomonee Falls – the Village sought access to Milwaukee’s water supply due to dropping water levels and increased contamination in some Village wells

**1990** – The population of the Village of Menomonee Falls is 26,840 – 25.8 percent of the population is 19 or under and the average household size is 2.7 persons

**Early 1990s** – Cousins Subs relocates its headquarters from Milwaukee to Menomonee Falls

**1990s** – 43 subdivisions are platted and nearly 2,000 single family homes are built, leading to the first decade of population increase in the Village since the 1960s

**1990** – The Cambridge Heights Apartments are constructed west of Appleton Avenue

**1990** – A *Land Use and Transportation System Plan for the Village of Menomonee Falls* is approved to update the 1973 plan – the plan includes recommendations for multi-use trails along river corridors and around the Tamarack Preserve

**1990** – Home construction begins the Ridgefield and Aberdeen subdivisions

**1990** – Menomonee Falls adopts its first master plan for the historic downtown area and begins to brand the area as the Village Centre

**1990** – The Persian Gulf War begins and local men and women serve in the conflict

**1991** – The Main Street Bridge is rebuilt and the first new ornamental lighting is installed in downtown

**1991** – Bradley Corporation expands its Menomonee Falls headquarters complex adding manufacturing and warehouse space

**1991** – The Danell Heights condominium development begins off of Fond du Lac Avenue

**1991** – A restroom/public meeting house constructed at Old Falls Village historical park

**1991** – Home construction begins in the Cedar Ridge Subdivision

**1991** – The building that houses the Honey Bucket Saloon and Heebie Jeebies Tavern/Restaurant catches fire and burns to the ground at the corner of Main Street and Water Street

**1992** – Kohl's opens a retail store near County Line Road

**1992** – Home construction begins in the Mill Ridge Subdivision

**1992** – **The Village celebrates the 100<sup>th</sup> anniversary incorporation with the dedication of Centennial Plaza at the northeast corner of Main Street and Appleton Avenue**

In 1992, on the year the Village turns 100:

- George H. W. Bush is President of the United States and Bill Clinton is elected
- It is the first year following the dissolution of the Soviet Union
- It is the second year of public access to the world wide web and the phrase “surfing the internet” is popularized
- Michael Jordan averages 35.8 points per game as the Chicago Bulls repeat as NBA champions
- *End of the Road* by Boyz II Men tops the Billboard Charts
- The City of Milwaukee's population has declined and is now closer to 600,000
- The Village's population is approximately 28,000

- The 1992 Centennial Corporation organizes a year-long celebration of the 100<sup>th</sup> anniversary including a Centennial ball, cook book, fun run, variety show, time capsule, park improvements and ten day celebration – the celebration is so well received that it was repeated for over 20 years as Falls Fest

**1992** – A copper statue is erected by the Community League of Menomonee Falls in honor of the Village Centennial

**1993** – The Village Centre Business Improvement District (BID) is founded to promote the development, redevelopment, maintenance, operation and promotion of downtown Menomonee Falls

**1993** – Target opens a retail store near County Line Road

**1993** – Home construction begins in the Single Tree and Brook Falls Estates subdivisions, and the Arboretum retirement community is constructed on Town Hall Road

**1993** – Lilly Road is reconstructed between Hampton Road and Silver Spring Drive

**1993** – The Cancer Care Center opens at Community Memorial Hospital

**1994** – Metro Harvest Church is founded along east County Line Road

**1994** – The Village purchases the 1893 Koehler-Zahn house on Appleton Avenue – the house is later utilized as an office for the Falls Fest organization, Senator Alberta Darling and the Menomonee Falls Chamber of Commerce

**1994** – Enrollment reaches a low point at Menomonee Falls High School – the graduating class has fewer than 300 for the first time in decades

**1994** – On the 100<sup>th</sup> anniversary of the Fire Department, a new station is dedicated at the intersection of Highway 145 and Main Street in the northeast area of the Village – this location had been the site of Bailey Elementary School

**1994** – The Village reaches an agreement with Waste Management Incorporated allowing for continued operation of the Orchard Ridge landfill in exchange for monthly “tipping fees” to fund municipal infrastructure and facilities

**1994-1995** – Alto-Shaam Incorporated doubles the size of its Menomonee Falls headquarters

**1995** – Menomonee Falls develops a strategic plan and vision for the Village – today, this goals in the strategic plan provide the basis for the Village’s Comprehensive Plan vision

**1995** – Home construction begins in the Lilly Creek, Creekwood Crossing and Hidden Meadow subdivisions and construction begins on the Dalles condominiums and Mill Pond Plaza along Main Street

**1995** – Shady Lane is extended between Menomonee Avenue and Custer Lane

**1995** – Pick n’ Save opens a new grocery store along County Line Road

**1995-1996** – Silver Spring Corporate Park is developed and Kohl’s corporate headquarters opens in Menomonee Falls – an important part of this development is the installation of sanitary sewer through the southwestern area of the Village along Silver Spring Drive which opens up the corridor to future development

**1996** – Village Board approves the settlement which ends the “Sewer Wars” era between Milwaukee Metropolitan Sewerage District and seven suburban communities

**1996** – Prince of Peace Lutheran Preschool opens on Pilgrim Road

**1996** – The Menomonee Falls Community Center opens to the public

**1996** – Pilgrim Road is reconstructed between Appleton Avenue and Main Street, and Roosevelt Drive Bridge is reconstructed at the north end of the Mill Pond

**1996** – Development of Oakwood Park begins

**1996-1997** – Menomonee Falls Little League complex is built along Mill Road

**1997** – Home construction begins in the Winter Hollow subdivision

**1997** – A picnic shelter and restrooms are constructed at Mill Pond Park

**1997** – Good Hope Road is reconstructed east of Pilgrim Road

**1997** – Aquinas Academy opens along Good Hope Road

**1997** – The Menomonee Falls Scholarship Foundation held its first scholarship telethon on Cable Access Channel 14 – the telethon is held for five consecutive years raising an estimated total of \$150,000 for college scholarships

**1997-1998** – Marcus Menomonee Falls Cinema is constructed on the north side of the Village

**1998** – Construction begins at Woodland Prime Business Park north of Good Hope Road at the eastern Edge of the Village

**1998** – The Milwaukee Catholic Symphony Orchestra is renamed as the Menomonee Falls Symphony Orchestra (MFSO) and begins performing in the Village – today the MFSO performs out of the Hamilton High School Fine Arts Center which was completed in 2004

**1998** – There are an estimated 2,100 on-site residential sewerage (septic) systems in use within the Village – the remaining 10,900 housing units (84 percent of the total in 1998) are connected to centralized public sewer systems

**1998** – Waukesha County Technical College begins holding classes at the Community Center

**1999** – Following a negotiation which includes Milwaukee's annexation of a Village site for the development of Ambrosia Chocolate factory, Menomonee Falls homes and business within the Lake Michigan watershed are connected to the City of Milwaukee's water service

**1999** – Main Street (State Route 74) and Appleton Avenue (State Route 175) are reconstructed in downtown Menomonee Falls with red brick bordered sidewalks

**2000** – The population of the Village of Menomonee Falls is 32,647, 26.7 percent of the population is 19 or under and the average household size is 2.5 persons

**2000** – Construction begins at Westbrook Corporate Center along Old Orchard Road and 124<sup>th</sup> Street is extended and widened between Main Street and Fond du Lac Avenue

**2000** – Construction begins on Wildwood Highlands senior apartments

**2003** –The War in Afghanistan begins and many local men and women serve in the conflict – the majority of American military operations end in 2014, but many military personnel remain today

**2001-2003** – Village Hall and the municipal complex is renovated and expanded

**2002** – Home construction begins in the River Heights subdivision

**2002** – Home Depot opens in northern Menomonee Falls

**2003** –The Iraq War (Operation Iraqi Freedom) begins and many local men and women serve in the conflict – major American involvement the war ends in 2011, but many military personnel remain today

**2003** – The new Menomonee Falls Public Library is dedicated east of Village Hall – Over 500 individuals, businesses and organizations contribute to an extensive fundraising campaign for the project

**2003** – The Friends of Lime Kiln Park group is established following a proposal to create an event space in the park – the group petitions Village leadership to designate the park as a natural area and, in 2006, to adopt a natural areas management and maintenance plan for the park

**2003** – Three park shelters are constructed at Oakwood Park

**2004** – Home construction begins in the Hidden Crossing, Harmony Hills, and Taylors Woods subdivisions

**2004** – Restrooms are remodeled at Village Park

**2005** – Briggs & Stratton Corporation builds a combined manufacturing and office facility along Old Orchard Road and 124<sup>th</sup> Street

**2005** – County Line Road is reconstructed between Lannon Road and Appleton Avenue

**2005** – Several new businesses (including Steinhafel’s Furniture, Best Buy and Uno’s Pizzeria) are constructed in northern Menomonee Falls

**2000s** – 27 subdivisions are platted adding over 1,000 new residential lots

**2007** – Restrooms are remodeled at Willowood Park

**2008** – The Village adopts the *Menomonee Falls Comprehensive Plan* which was developed in compliance with Wisconsin Smart Growth planning legislation

**2008** – Home construction begins in the Crane’s Crossing and Spencer’s Pass subdivisions

**2008** – Restrooms are remodeled at Rotary Park

**2008-2009** – A nation-wide recession impacts the local and regional economy with job cuts and development slow-downs across all economic sectors

**2009** – Radisson Hotel opens at Main Street and US 41/US 45 (now interstate 41)

**2009** – Riverside Park/Trenary Field bleachers and restrooms are renovated

**2009** – Pilgrim Road is reconstructed from Megal Court to County Line Road

**2010** – The population of the Village of Menomonee Falls is 35,626, 24.8 percent of the population is 19 or under, the average household size is 2.4 persons

**2010** – Urban land uses occupy about 54 percent of the Village’s land area

**2010** – Woodman’s is constructed along 124<sup>th</sup> Street and a new Pick n’ Save grocery store is built on the former location of Kmart along Appleton Avenue

**2010** – Grace Evangelical Lutheran Church is constructed along County Line Road

**2010s** – Seven new residential subdivisions are platted through 2016

**2011** – Froedtert constructs a large medical office building across from Community Memorial Hospital

**2011** – New playground equipment is installed at Willowood Park and Rotary Park

**2012** – Pilgrim Village shopping center is redeveloped at the corner of Main Street and Pilgrim Road

**2012** – The Protective Services Department is created as a combination of the Fire Department and Police Department – Anna Ruzinski is named chief of the new department

**2012** – A building at Shady Lane Nursery catches fire threatening the businesses Christmas flowers – firefighting crews from Menomonee Falls and surrounding communities contain the blaze and assist in relocating the flowers to preserve them for the Christmas Holiday

**2013** – Froedtert and Wisconsin Athletic Club occupy a new multi-tenant building at the former site of the Stolper Steel factory

**2013** – Menomonee Falls High School wins the girls volleyball state championship

**2014** – The Village constructs a new multi-use recreational trail along Fond du Lac Avenue

**2014** – Home construction begins in the Weyerhaven and Silver Spring Estates subdivisions

**2015** – Fire Station No. 1 is relocated to west Main Street and Fire Station No. 5 opens on Silver Spring Drive

**2015** – The White Stone Station redevelopment project is approved, transforming an area of vacant and underutilized industrial buildings into a mix including retailers (including Costco Wholesale), restaurants and a hotel

**2015** – The Woodlands Apartments open along Good Hope Road

**2015-2016** – Menomonee Falls High School wins back to back state baseball championships

**2016** – The Village adopts the *2015 Comprehensive Plan Update* addressing economic development and health and public safety for the first time

**2016** – The population of the Village of Menomonee Falls is 36,907

**2016** – Home construction begins in the Christman Park and Fox Meadow subdivisions

**2016-2017** – The Junction Apartments open along Falls Parkway



**2016** – Pilgrim Road bridge and the Pilgrim Road and Main Street intersection are reconstructed

**2016** – Thomas Jefferson Middle School and Hiawatha Elementary School are demolished as part of a School District facility modernization plan – the former associated bank building on Main Street is demolished to make way for the Riverwalk on the Falls apartment project

**2016** – Menomonee Falls High School graduates number around 450 – this is a 29 percent increase from 1994

**2017** – Home2 Suites Hotel opens along Falls Parkway and Fresh Thyme Farmers Market opens along Appleton Avenue

**2017** – The Village celebrates the 125<sup>th</sup> anniversary of its incorporation

- Donald J. Trump is President of the United States
- *Shape of You* by Ed Sheeran tops the Billboard Charts
- 13 years after its founding Facebook (a popular social media site) has 1.9 billion monthly active users
- The United Kingdom begins its formal withdrawal from the European Union
- The City of Milwaukee's population remains at roughly 600,000
- The Village's population is over 37,000
- Through the first quarter, 46 building permits are issued for new single family homes, marking the second year in a row where the Village leads all communities in Southeast Wisconsin for housing starts